

Lyric™

Life in tune.

Honeywell

Quick Install Guide



Getting Started

This guide will walk you through the following steps:

- **Remove your old thermostat**
- **Record existing wiring & disconnect**
- **Attach your new Lyric thermostat**

You can use this guide to remove your old thermostat and mount your new one.

You will need the Lyric app to complete setup.

Compatibility

- The Lyric thermostat works with common 24 volt systems such as forced air, hydronic, heat pump, oil, gas and electric.
- Does not work with electric baseboard heat (120/240V).

Need help?

- **Web:** lyric.honeywell.com
- **Email:** MyLyric@honeywell.com
- **Social:** Twitter, Facebook, & Google+
- **Phone:** 1-800-633-3991

Included in your box:



Thermostat



Wallplate



Mounting Screws



Trim Ring

You will need:



Ballpoint Pen



Phillips Screwdriver

You may also need:

Wi-Fi Password

Small Flathead Screwdriver

Needle-Nose Pliers

Wire Stripper

1 Turn OFF power

Important! To protect yourself and your equipment, turn OFF the power at the breaker box or switch that controls your heating/cooling system.



Make sure the power is OFF

Try turning ON your heating/cooling system by changing the temperature. If you can't get the system to turn ON in 5 minutes, you'll know the power is OFF.

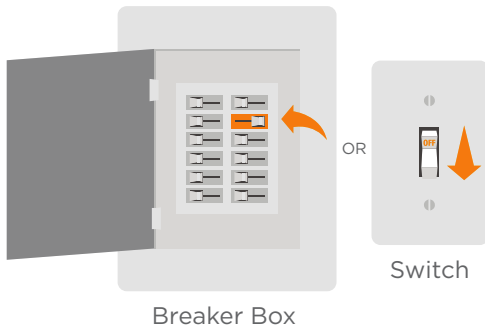

2 Take the faceplate off your old thermostat

On most thermostats, you can take off the faceplate by grasping and gently pulling or popping it off. Some thermostats may have screws, buttons, or clasps holding the faceplate on.

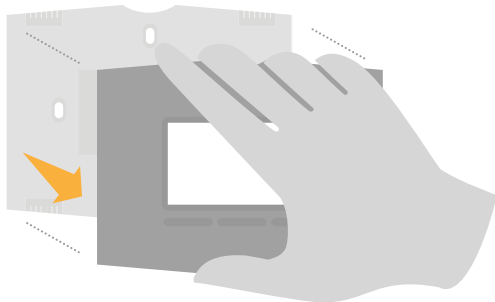

3 Take a picture of how your wiring looks right now



This picture will come in handy when you're installing your new Lyric thermostat.

4 Make sure there are no 120/240V wires



Do you have thick black wires with wire nuts? Is your thermostat 120V or higher? If yes, you have a line voltage system, and the Lyric thermostat will not work. For more thermostat options, please visit: wifithermostat.com

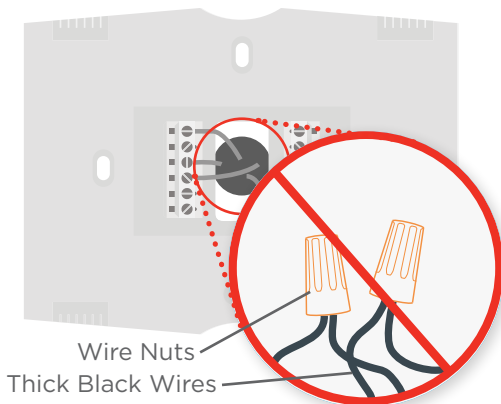

5 Record any jumpers & R-wire configuration

A jumper is a connector between two terminals. Do not use any jumpers with Lyric, they're not needed. Record any jumpers: _____

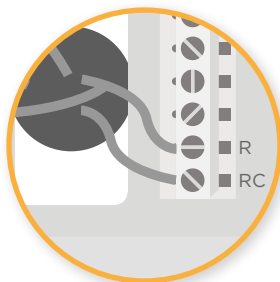
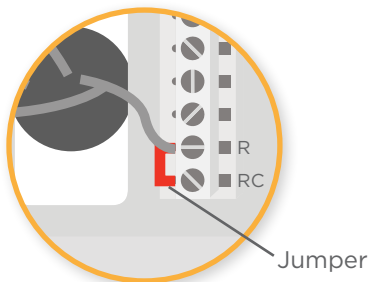

Check the box that applies to you. You will need this information in **Step 9:**

A I only have one R-wire and it is connected to the R or RC or RH terminal

B I have one wire connected to R and one wire connected to RC

6 Record existing wires & disconnect

Use the space below to record the color of the wires that are plugged into the terminals of your old thermostat wallplate.

Note: You will need to refer to this information in **Steps 9 and 10**.

Common

Select Old Terminal	Add Wire Color
<input type="checkbox"/> AUX	_____
<input type="checkbox"/> B	_____
<input type="checkbox"/> C	_____
<input type="checkbox"/> E	_____
<input type="checkbox"/> G	_____
<input type="checkbox"/> HUM	_____
<input type="checkbox"/> K	_____
<input type="checkbox"/> L	_____
<input type="checkbox"/> O/B	_____
<input type="checkbox"/> O	_____
<input type="checkbox"/> R	_____

Select Old Terminal	Add Wire Color
<input type="checkbox"/> RC	_____
<input type="checkbox"/> RH	_____
<input type="checkbox"/> U	_____
<input type="checkbox"/> U1	_____
<input type="checkbox"/> U2	_____
<input type="checkbox"/> VNT	_____
<input type="checkbox"/> W	_____
<input type="checkbox"/> W2	_____
<input type="checkbox"/> Y	_____
<input type="checkbox"/> Y2	_____

Uncommon

Select Old Terminal	Add Wire Color
<input type="checkbox"/> F	_____
<input type="checkbox"/> H	_____
<input type="checkbox"/> P	_____
<input type="checkbox"/> T	_____
<input type="checkbox"/> U	_____
<input type="checkbox"/> V/VR	_____
<input type="checkbox"/> W3	_____

Tip: You can also use the wiring guide in the Lyric app to create a diagram of how to wire your new wallplate.



If you have uncommon wiring, visit the Honeywell Wiring support page for instructions on setting up your Lyric thermostat with unique wiring:

lyric.honeywell.com/wiring

7 Disconnect wires & remove the old thermostat's wallplate



Make sure the power is OFF.

Tip: To prevent wires from falling back into the wall, wrap the wires around your ballpoint pen.

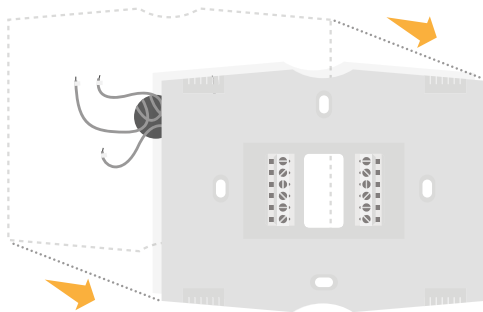

Optional: Attach the trim ring to your wallplate

Attach your optional trim ring to the wallplate by snapping the two together.

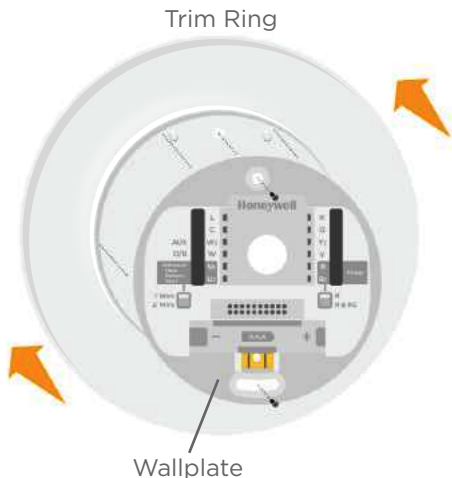

8 Bundle and insert wires through the wallplate

Gather your wires together and guide them through the hole on the back of the wallplate.

Do not remove the clear, rubber wire holder.

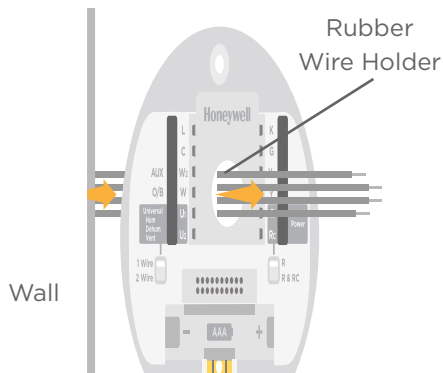

9 Set R slider tab

If you selected **Option A in Step 5**, keep the slider tab in the R position and insert your R or RC or RH wire into the R terminal.

If you selected **Option B in Step 5**, move the slider tab to the R & RC position and insert your R wire into the R terminal and RC into the RC terminal.



Tip: Make sure at least $\frac{3}{8}$ " of the wire is exposed.

Tip: You can use a needle-nose pliers to push the wires gently into the terminals all the way.

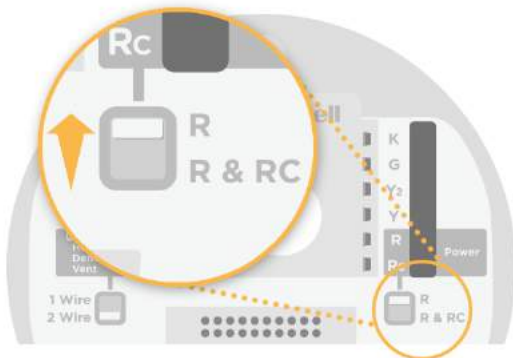

10 Connect wires

Connect the remaining wires according to terminals you recorded in **Step 5**.



Confirm the wires are firmly attached by gently tugging on them.

Tip: You can use a ballpoint pen to release misplaced wires by pushing down on the terminals.

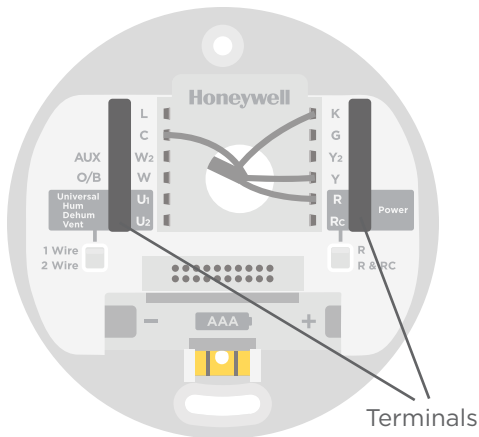

11 Mount the wallplate

Mount the wallplate for your Lyric thermostat using the **provided screws**. Make sure the wallplate is level by keeping the bubble between the two lines.

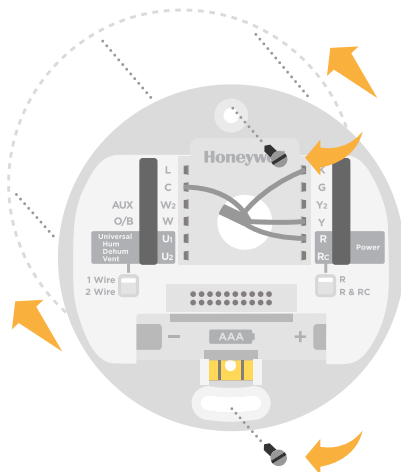

12 Attach your Lyric thermostat

Align your Lyric thermostat onto the wallplate and firmly snap it into place. The thermostat will glow and pulse for up to 3 minutes while it starts up.

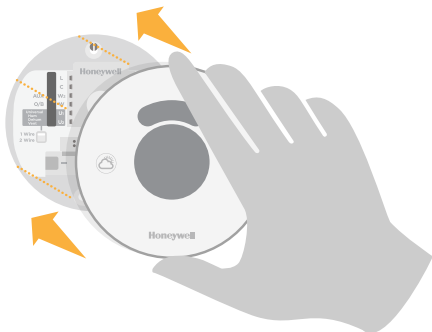

13 Turn your power ON

Turn ON the power at the breaker box or switch that controls your heating/cooling system.

Congratulations! You've successfully installed your Lyric thermostat.

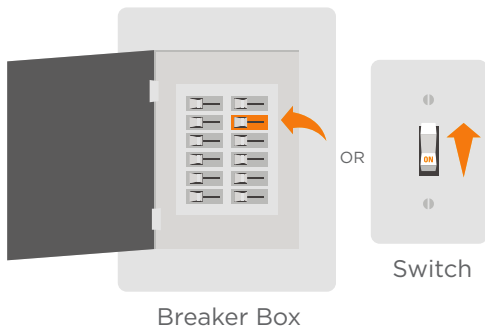

14 Download the app

To configure your new thermostat and finish setup, download the app by searching for **Honeywell Lyric** in the App Store or Google Play.

After downloading, follow the instructions in the app and **skip the install step**.

 **Caution:** Your Lyric thermostat will not control your heating/cooling system until you finish setup in the Lyric app.



Lyric



Need help troubleshooting? Visit lyric.honeywell.com/support/troubleshooting

Lyric™

Life in tune.

Honeywell

Automation and Control Solutions

Honeywell International Inc.

1985 Douglas Drive North

Golden Valley, MN 55422

lyric.honeywell.com

1-800-633-3991

12/18/14